



# climate extremes

ARC centre of excellence

## 2018 Annual Workshop

*Wollongong, New South Wales*

### Welcome

Thank you for participating in the ARC Centre of Excellence for Climate Extremes Annual Workshop for 2018. We are delighted to have you here and trust that the workshop will be intellectually stimulating and also afford excellent opportunities to spend time with colleagues and make new connections to expand your professional network.

For this inaugural CLEX workshop, we wanted the emphasis to be on introducing centre staff and students to the science and strategic direction underpinning the new centre. The workshop is also an opportunity to forge networks and collaborations across research programs, opening up for new connections and research possibilities.

Whether you are a student, early career researcher, technical programmer or seasoned scientist, the agenda – which is made up of primer sessions, plenary talks, poster/ poster feedback sessions and professional development talks – will no doubt prove to be engaging and informative.

This guide provides information on the agenda and all your need-to-know workshop logistics. If you have any questions not covered by this guide, please get in touch with Jenny Rislund or Stephen Grey.

## **ARC Centre of Excellence for Climate Extremes**

The ARC Centre of Excellence for Climate Extremes (CLEX, or sometimes simply referred to as the CoE) is a research consortium of five Australian universities and a suite of outstanding national and international partner organisations.

The centre is building upon the success of the ARC Centre of Excellence for Climate System Science, which concluded in June 2018.

The overarching vision of our centre is to:

*Our goal is to transform our understanding of the processes that cause climate extremes, including their dependence on climate change and variability, and to use this process-based understanding to revolutionise our capability to predict future climate extremes.*

This vision becomes all the more tangible and immediate when we gather as a whole Centre. We are happy to welcome you to our annual workshop, held at Novotel, Wollongong.

## **Acknowledgement of Country**

We acknowledge the Wodo Wodi people of the Dharawal Nation, the traditional custodians of the land we are meeting on and we pay our respects to elders past, present and emerging.

## **Our Commitment to Respect and Diversity**

Gender, ethnicity, sexuality, age, disability and other personal characteristics should not be impediments to your full engagement and enjoyment of the CLEX workshop. Nor should such personal traits be grounds for language or actions from any workshop participants that are discriminatory or intimidating. By attending the workshop you agree to abide by standards that are ethical, respectful and considerate of all other workshop attendees and venue staff at all times.

## **Registration & Icebreaker**

Registration will commence from 4pm on Sunday, November 18th on the mezzanine floor, Novotel Northbeach Wollongong. Please hang your poster between 4 – 6 pm.

An informal icebreaker will be held in the Admiral's Room from 6pm. Canapés and refreshments will be served. Additional beverages may be purchased at delegates' own expense.

Please collect your lanyard and find your fellow networking circle members (see below) during this icebreaker session.

## Networking Circles

Networking circles were developed to facilitate interaction and discussion among workshop attendees that may not have occurred otherwise. They also enable younger researchers to benefit from the experience and advice of more senior colleagues. Your group number is on your lanyard and you will be seated with your group at the workshop dinner on Monday night. Do use this time to get to know the members of your group. You will note that your group consists of people from a range of institutions, research programs, and levels of research "age".

It is our hope that the relationships you form with those in your group during our networking/ice breaking adventures continue throughout the workshop, and beyond. Therefore, we have included a couple additional tasks for you to complete throughout the next few days...

1. **All** - visit the posters of the members of your networking circle.
2. **Mid-late career researchers** - introduce the early career researchers in your circle to at least one person you think they should know.
3. **Early career researchers** - ask mid-late career researchers in your circle about the greatest challenge faced in their career thus far, and how they overcame it.

## Posters and poster sessions

All workshop attendees are encouraged to bring a poster and those who are bringing a poster are invited to attend the poster feedback sessions.

All attendees bringing a poster will be asked prior to the workshop to register their poster through the website; upon registration your poster will be assigned a number. When you arrive in Wollongong, please find your way to the Grand Ballroom/Throsby Room on the mezzanine floor where you will be asked to hang your poster on the poster board with the corresponding number.

Poster can be hung Sunday afternoon (4-6pm) or Monday morning (8-8:30am).

**It is your responsibility to keep your own poster tube.** Tubes left in the poster room are unlikely to find their way back to their original owner and will not be stored for you.

## Social Media

We encourage participants to engage with social media. Our Twitter and Instagram hashtag for the conference is **#CLEX18**.

To ensure that we maintain a level of professionalism and respect for our colleagues, we have developed this short guideline for social media use. Most of it, as expected, is straight forward common sense, but please familiarise yourself with our social media guidelines before posting.

Social media guidelines and information can be found on the CLEX website:  
<https://climateextremes.org.au/clex-social-media-guidelines/>

# Transport

## Travelling from interstate

Flights should be organised to allow sufficient time to get to Wollongong by mid-afternoon on Sunday 18 November 2018 and with time to get back to the airport after the workshop. Please book your flights according to your local travel policy. Your node CLEX admin person can assist.

Remember also to report your travel and attendance at the workshop in [clever](#). If you're attending the additional ECR and CI meeting after the workshop, please factor this into your flight booking. Limited parking is available at the Novotel on a first come basis. Parking is complimentary for guests staying at Novotel and for those who are not guests it is \$20 overnight. Please see reception.

## Sydney Domestic Airport to Wollongong

### *Train from Sydney domestic airport*

1. Go to the airport station's platform 2.
2. Catch the train to Wollongong and change to platform 4 for your train to Wollongong (The South Coast line)

Travel time is approximately 1.5 hours. For timetables and more information see [www.transportnsw.info](http://www.transportnsw.info)

### *Free Shuttle bus from Wollongong Station to Novotel Northbeach/ Adina Apartments/ Wollongong CBD*

The Gong Shuttle is a free shuttle bus service (buses 55a and 55C) running in a loop from the station around the city, stopping right in front of Novotel Northbeach, Adina Apartments and the Belmore.

Hours of operation are:

Weekdays: 07:00 – 18:00 every 10 minutes, 18:00 – 22:00 every 20 minutes

Saturdays: 08:00 – 18:00 every 20 minutes

Sundays & Public Holidays: 09:40 – 17:20 up to 20 minute frequency

### *Taxis*

A list of local taxi services can be found below. When possible, please use the free shuttle service rather than taxis/ubers.

Illawarra Taxi Network: (02) 4254 2111

Wollongong Radio cabs: (02) 4254 2121



## Venue

Novotel Northbeach 2-14 Cliff Rd, North Wollongong NSW

All CIs, Admin team, CMS team and invited speakers will be staying at Novotel Northbeach. The workshop will be held here from Monday to Wednesday on the mezzanine floor, as will the ECR Day and the CI meeting on Thursday the 22<sup>nd</sup>.

**Telephone:** (02) 4224 3111

**Website:** [www.novotelnorthbeach.com.au](http://www.novotelnorthbeach.com.au)



## Checkout

Rooms need to be **vacated by 11:00am** on the final day of the workshop (unless you are staying on until Thursday). Please allow enough time in the morning to complete checkout formalities and store your luggage in the designated area in the workshop venue.

## Wifi

Wifi will be provided throughout the conference center and hotel rooms. (There may be separate information in the Novotel Hotel Welcome Park and at the reception desk for guests staying in-house). To login, use the details below:

**Wifi Name:** Novotel Conference Network

**Password:** clex2018

# Novotel Northbeach Conference Centre Map

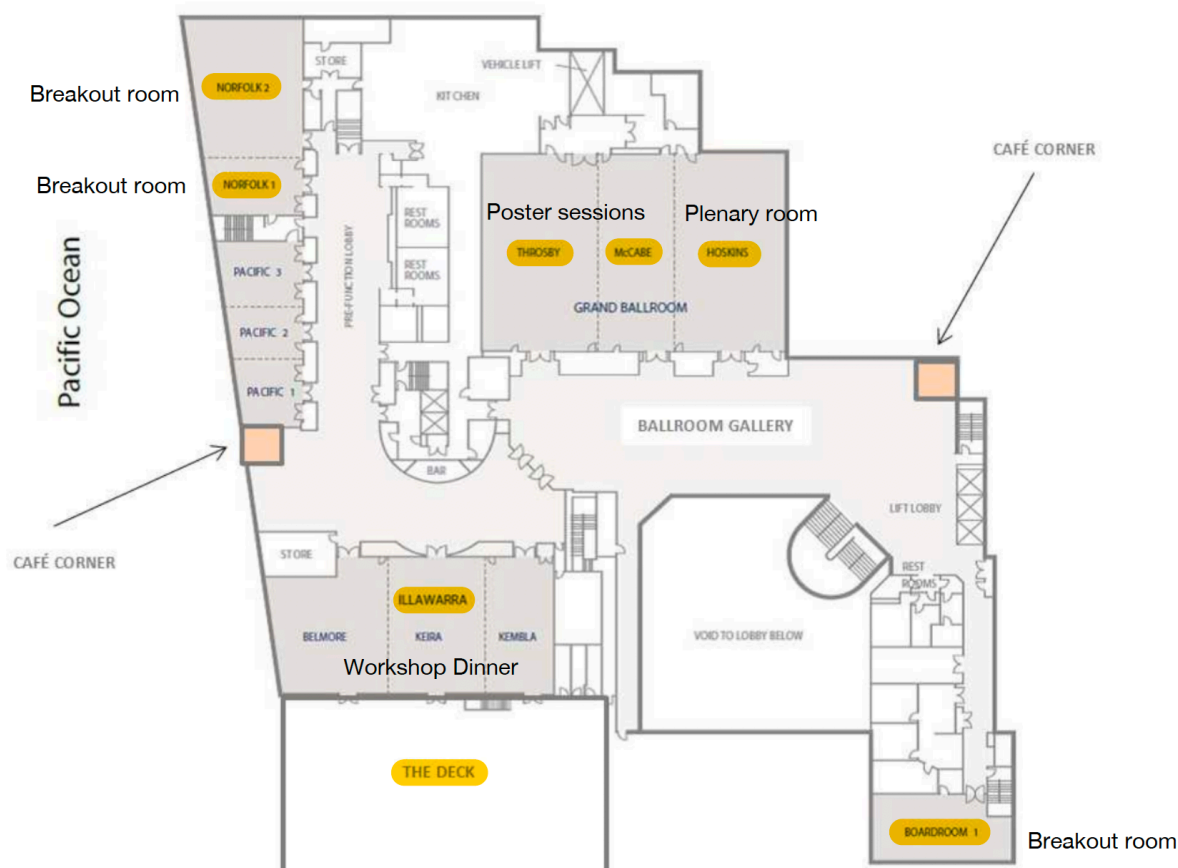

## Food

A day delegate package of morning/afternoon tea and lunch will be provided throughout the conference for registered attendees. Those who indicated dietary requirements when registering will be catered for throughout the week.

There will also be a coffee cart outside the Plenary room workshop serving complimentary beverages for workshop attendees. Any other drinks and items purchased from the restaurant/bar are to be paid in cash upon consumption rather than charged back to room accounts so as to avoid delays or disputes when settling the room account.

## Social Events

**Sunday Night:** 6.00pm Welcome drinks and canapés

**Location:** Admiral's Room, Novotel Northbeach

Canapés and drinks will begin at 6.00pm at the Admiral's Room, Novotel Northbeach. This is where you will pick up your lanyard, meet your networking circle and catch up with colleagues from across the centre. You will then have free time to have dinner and explore Wollongong in the evening.

There will initially be a bar tab that will enable everyone to have one or two drinks. Once our tab limit has been reached, additional beverage consumption will be at delegates' own (private) expense. Cash or card will be accepted here.



**Monday Night:** Workshop Dinner

**Location:** The Deck and Illawarra Room, Novotel Northbeach

The Workshop Dinner will be held at the Novotel Northbeach at 6pm. A buffet dinner and some drinks will be provided. Additional beverage consumption will be at delegates' own expense.

**Tuesday Afternoon:** Outdoor/sporting activities.

Our workshop location is opposite Wollongong North Beach and close to a couple of parks and pleasant coastal walk. Other past activities have included board games, meditation and yoga. We'd love some volunteers to bring sporting equipment or organise an activity.

**Tuesday Evening** Explore Wollongong

There will be free time on Tuesday night for you to explore Wollongong for dinner.

## Workshop Committee



**Jenny Rislund**

***Executive Assistant***

Phone: 02 9385 9393 / 0424 622 411

Email: [j.rislund@unsw.edu.au](mailto:j.rislund@unsw.edu.au)



**Stephen Gray**

***Chief Operations Officer***

Phone: (02) 9385 7002 / 0403 802 027

Email: [stephen.gray@unsw.edu.au](mailto:stephen.gray@unsw.edu.au)



**Michael Reeder**

***Chief Investigator***

Phone: (02) 6125 0917

Email: [michael.roderick@anu.edu.au](mailto:michael.roderick@anu.edu.au)



**Andy Hogg**

***Chief Investigator***

Phone: (03) 6226 2027

Email: [neil.holbrook@utas.edu.au](mailto:neil.holbrook@utas.edu.au)



**Amelie Meyer**

***Postdoc***

Email: [amelie.meyer@utas.edu.au](mailto:amelie.meyer@utas.edu.au)



**Elaine Fernandes**

***Knowledge Broker***

Phone: (03) 8344 7453 / 0414 081 927

Email: [elaine.fernandes@monash.edu](mailto:elaine.fernandes@monash.edu)